

M5 Junction 25 Improvement Scheme

26th April

UPDATE

This is a short update on progress at Junction 25. We're pleased to confirm the important planning and site preparation works are now largely complete and we're moving on to the main construction programme. This means you will start to see more activity on site around Junction 25 from next week, although this will continue to be offline with no immediate impact on traffic.

The next phases of work will include establishment of site boundaries, earthworks near the Gateway Park & Ride, and removal of asbestos from the Cambria Farm buildings. We'll also be diverting the bridleway near Cambria Farm and preparing to drill trial holes and start work on widening the gyratory around the Junction 25 roundabout.

We'll have more information about this in our latest newsletter due to be issued next week. In the meantime, you can find out more about the scheme at www.travelsomerset.co.uk/J25 - or get in touch if you have any questions.

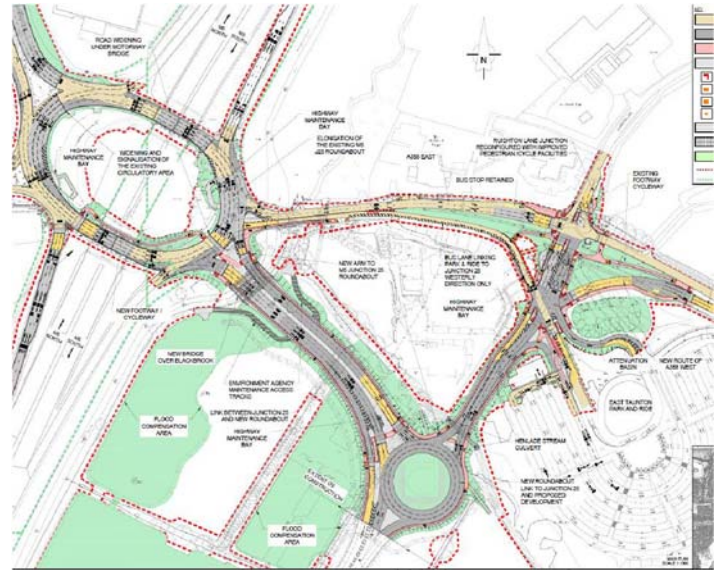

We would be pleased to hear your comments.

You can get in touch via our web site community.alungriffiths.co.uk or by contacting Rosemarie Harrod on 0330 041 2184* or M5J25@alungriffiths.co.uk
Calls to this number are charged at national call rates and included in inclusive minute plans from landlines and mobiles

Travel Somerset – for live travel alerts, roadworks information and winter weather updates

On Twitter @TravelSomerset and online 24/7 at www.travelsomerset.co.uk - <https://www.travelsomerset.co.uk/j25/>